

SHEET INDEX

SHEET 1	COVER SHEET
SHEET 2	VILLAGE #1
SHEET 3	VILLAGE #2
SHEET 4	VILLAGE #2 CONTINUED
SHEET 5	VILLAGE #3
SHEET 6	VILLAGE #4
SHEET 7	VILLAGE #5
SHEET 8	VILLAGE #6
SHEET 9	VILLAGE #7
SHEET 10	VILLAGE #8
SHEET 11	VILLAGE #8 CONTINUED

LEGAL DESCRIPTION

"NAME" PLANNED UNIT DEVELOPMENT
 LOCATED IN SECTION __, AND SECTION __, TOWNSHIP __, SOUTH, RANGE __, EAST, MOUNT DIABLO BASE AND MERIDIAN, WITHIN THE CITY OF MESQUITE, CLARK COUNTY, NEVADA AND BEING PARTICULARLY DESCRIBED AS:

ALL OF PARCEL __, PARCEL __ AS RECORDED ON THE MAP OF DIVISION INTO LARGE PARCELS FOR THE CITY OF MESQUITE, IN FILE __, PAGE __ OF MISCELLANEOUS MAPS IN THE OFFICIAL RECORDS OF CLARK COUNTY, NEVADA.

CONTAINS ____ ACRES.

TOGETHER WITH:
 ALL OF PARCEL __ AS RECORDED IN THE PARCEL MAP FOR MESQUITE VISTAS, IN FILE __, PAGE __ OF PARCEL MAPS IN THE OFFICIAL RECORDS OF CLARK COUNTY, NEVADA.

CONTAINS ____ ACRES.

TOGETHER WITH:
 ALL PARCEL __ AS RECORDED ON THE PARCEL MAP FOR MESQUITE VISTAS, IN FILE __, PAGE __ OF PARCEL MAPS IN THE OFFICIAL RECORDS OF CLARK COUNTY, NEVADA.

CONTAINS ____ ACRES.

TOTAL ACREAGE ____ ACRES.

CONSTRUCTION PLANS/COVER SHEET

OF "NAME" SUBDIVISION UNIT ?, PHASE ?

"NAME OF OWNER/DEVELOPER"

OWNER/DEVELOPER ADDRESS

MESQUITE, NEVADA 89024

PHONE

FAX



MESQUITE, NEVADA VICINITY MAP

NO SCALE
 BENCH MARK BASED ON NGVD 1929, NGS MONUMENT Z-405
 ELEV. = 1595.65
 TOP OF STAINLESS STEEL ROD IN CASING SET BELOW GROUND AT
 SOUTHEAST CORNER OF LDS CHURCH PROPERTY, NORTH SIDE OF
 MESQUITE BOULEVARD, WEST SIDE OF TOWN WASH.

BENCHMARK

ELEVATION DATUM: NGVD 1929
 TOP OF STAINLESS STEEL ROD IN CASING SET BELOW GROUND AT
 SOUTHEAST CORNER OF LDS CHURCH PROPERTY, NORTH SIDE OF
 MESQUITE BOULEVARD, WEST SIDE OF TOWN WASH.
 N.G.S. MONUMENT Z-405
 ELEV.=1595.65

DEVIATION FROM STANDARDS

NONE OR LIST EACH ONE.

APPROVAL BY THE CITY OF MESQUITE

J. ALLEN BELL P.E. DATE: _____
 CITY ENGINEER
 PE 4523

BILL TANNER DATE: _____
 DIRECTOR OF PUBLIC WORKS

KURT D. SAWYER DATE: _____
 DIRECTOR OF BUILDING

LEONARD T. DEJORIA DATE: _____
 FIRE PREVENTION OFFICER
 MESQUITE FIRE AND RESCUE

CATHERINE LORBEER, AICP DATE: _____
 PLANNING AND REDEVELOPMENT DIRECTOR

APPROVAL BY THE UTILITY COMPANIES

MICHAEL WINTERS DATE: _____
 VIRGIN VALLEY WATER DISTRICT

BOYD EVANS DATE: _____
 OVERTON POWER DIST. No.5

HAROLD OSTER DATE: _____
 RIO VIRGIN TELEPHONE CO.

ERIKS LUNDIN DATE: _____
 VIRGIN VALLEY DISPOSAL INC.

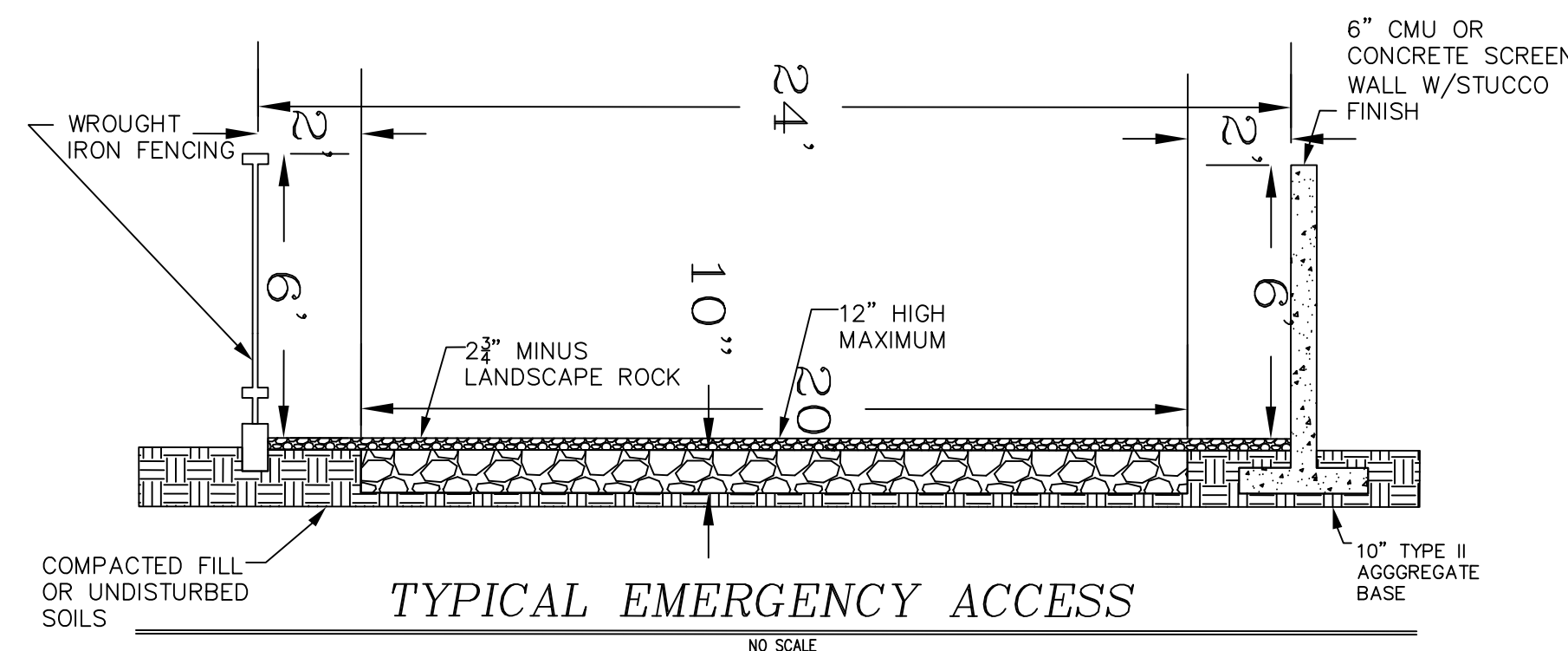
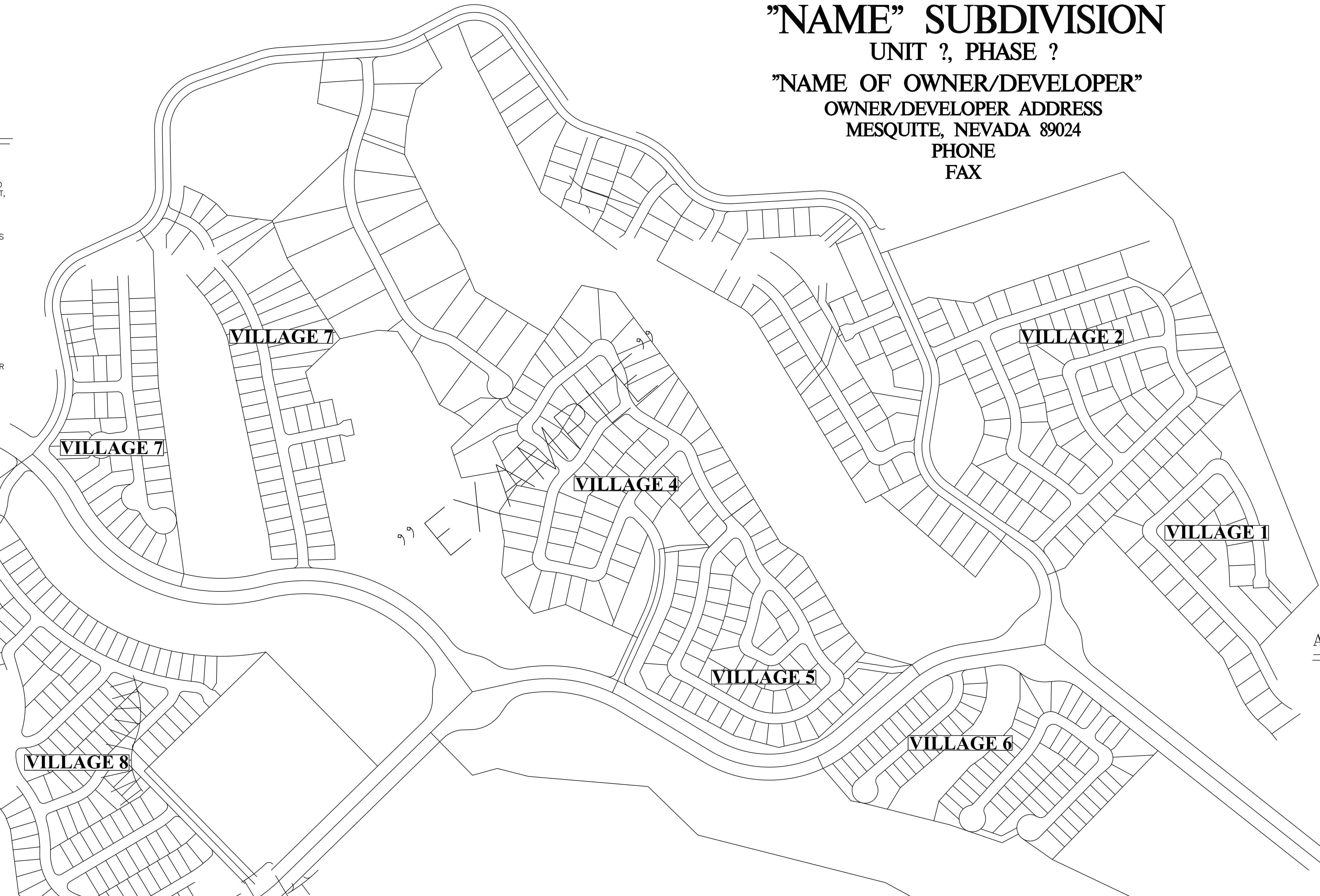

NOTES:

- THE PLANS HEREIN REPRESENT THE ENTIRE PROJECT TO BE COMPLETED IN A SINGLE PHASE.
- CERTIFICATE OF COMPLETION OR CERTIFICATE OF OCCUPANCY(S) WILL NOT BE APPROVED PRIOR TO COMPLETION OF ALL WORK SHOWN HEREIN.
- ALL WORK CONTEMPLATED BY THESE PLANS MUST BE COMPLETED WITHIN ONE YEAR OF THE DATE OF LAST APPROVAL BY THE CITY.
- SHOULD THE WORK NOT BE COMPLETED THE PLANS MUST BE RESUBMITTED FOR REVIEW AND RE-APPROVAL.

GRAPHIC SCALE

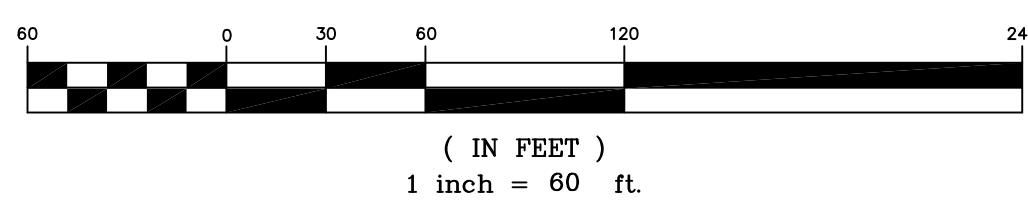

NO	REVISIONS DESCRIPTION	DATE	BY

"Company Title Block"

"Logo"

"Project Title etc."

PROJECT NO:	SCALE:	DRAWN BY:	CHECKED BY:
PROJECT:	DATE:	DRAWN:	CHECKED:
DATE:	DATE:	DATE:	DATE:
SHEET NO:	DATE:	DATE:	DATE:
1 OF 1			